



SANUSWALLET 2.0

INFO & GUIDELINE

Full version



SANUSCOIN
the green voucher



SANUSCOIN
the green voucher

SANUSLIFE INTERNATIONAL Srl
Via Luigi Negrelli Str. 13/C
39100 Bolzano, Italia



WWW.SANUSCOIN.COM

support@sanuscoin.com

© NOV 2021 SANUSLIFE INTERNATIONAL

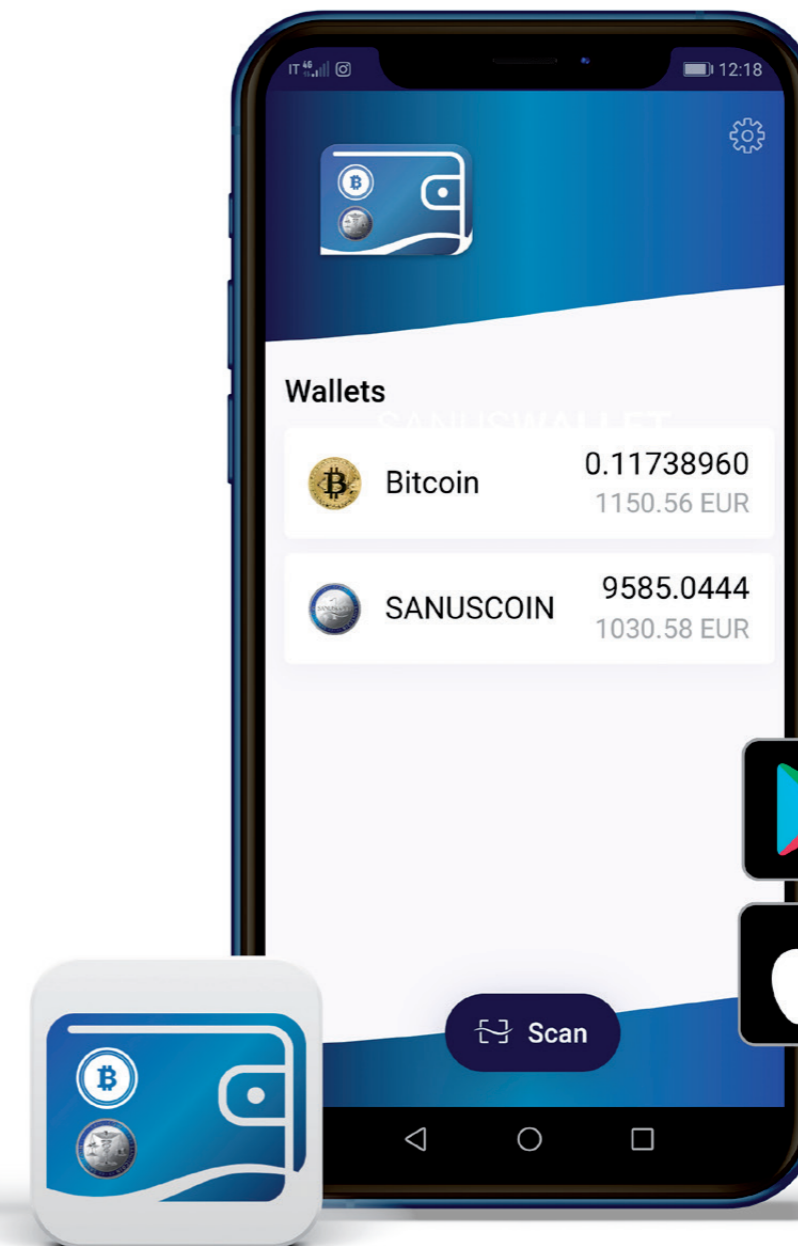

All rights reserved.

Reproduction and copying only with the permission of SANUSLIFE INTERNATIONAL Srl.

Image Copyrights: SANUSLIFE INTERNATIONAL, SdecoretMockup, x10 / stock.adobe.com

LIST OF CONTENTS

LIST OF CONTENTS	4
LIST OF ILLUSTRATIONS	5
1	Our electronic storage device: the SANUSWALLET! 6
1.1	What is the SANUSWALLET? 6
1.2	How to create a new SANUSWALLET (including backup) 6
1.3	How to restore an existing SANUSWALLET (import) 9
1.4	How to secure your SANUSWALLET from unauthorized access..... 12
1.5	How to receive and send Bitcoins (BTCs)..... 14
1.5.1	Receive BTCs 14
1.5.2	Send BTCs 16
1.6	How to receive and send SANUSCOINS (SACs) 18
1.6.1	Receive SAC 18
1.6.2	Send SAC 19
1.7	How to hide your credit balance 21
2	SANUSCREDITS and SANUSCOINS..... 22
2.1	Conversion of SC into SAC 22
2.2	How to transfer the converted SACs in the SANUSWALLET 23
2.3	Google Authenticator and Pairing 23
2.4	How to pair with the Authenticator! 24
2.5	Has the pairing failed? This could help you! 24
3	FAQ 26

LIST OF ILLUSTRATIONS

Figure 1:	SANUSWALLET start 7
Figure 2:	Privacy and terms of use 7
Figure 3:	Create a wallet 8
Figure 4:	Protect wallet with a password 8
Figure 5:	Backup required 8
Figure 6:	Secure your passphrase 9
Figure 7:	Import wallet 9
Figure 8:	Enter Passphrase 10
Figure 9:	Import wallet 10
Figure 10:	Secure wallet with a password 10
Figure 11:	Settings: Secure with PIN 12
Figure 12:	Lock wallet 12
Figure 13:	Select and enter a PIN 13
Figure 14:	BTC Wallet 14
Figure 15:	Receive BTC 14
Figure 16:	Copy BTC address 15
Figure 17:	BTC address copied 15
Figure 18:	Send BTCs 16
Figure 19:	Enter BTC receiving address 16
Figure 20:	Scan BTC receiving address 16
Figure 21:	Send BTCs 17
Figure 22:	SAC wallet 18
Figure 23:	Receive SACs 18
Figure 24:	Send SACs 19
Figure 25:	Copy/scan the SAC receiving address 19
Figure 26:	Send SACs 20
Figure 27:	Balance hidden 21

1 Our electronic storage device: the SANUSWALLET!

1.1 What is the SANUSWALLET?

SANUSCOINS can be stored and managed in a „SANUSWALLET,“ which SANUSLIFE INTERNATIONAL makes available for download free of charge. The SANUSWALLET is therefore an electronic storage and administration tool that enables the management of Bitcoins in addition to SANUSCOINS. Comparable to a wallet, only digital. Another advantage of this wallet is that you can see the current voucher value.

1.2 How to create a new SANUSWALLET (including backup)

If you are using an Android device, please proceed as follows:

- Open the "Play Store" app and enter „SANUSWALLET“ in the search field. Before you start the download, make sure you have a secure Internet connection and that your mobile data is enabled. Alternatively, you can use a WLAN connection.
- Now start the download by clicking > **Install**, then wait until the download is complete.

If you are using an iOS device, please proceed as follows::

- Open the Safari browser (Internet access required) and type following link: <https://wallet2.sanuscoin.com/>
- Save this web connection on your home screen by clicking > **Add to Home screen**.
- Now open the link on your screen.

Further steps for Android and iOS:

- Open the app and click > **Start** (Figure 1: SANUSWALLET start). After that, you need to accept all the items specified and then click > **Confirm & Finish** (Figure 2: Privacy and terms of use). Now select > **Create a Wallet** (Figure 3: Create a wallet) and specify if you want to secure the SANUSWALLET with a password (Figure 4: Protect wallet with a password). Make sure that you have written down the password correctly. There is no „Forgot password“ button, so the password cannot be recovered. Alternatively, you also have the option to secure your wallet later with a personal identification number (PIN) (see point 1.4 How to secure your SANUSWALLET from unauthorized access).



Figure 1:
SANUSWALLET start

Please review

- I understand that my funds are held securely on this device, not by a company.
- I understand that if this app is moved to another device or deleted, my coins can only be recovered with the passphrase.

- I have read, understood, and agree to the Terms of Use.

[View complete Terms of Service](#)

Confirm & Finish

Figure 2:
Privacy and terms of use

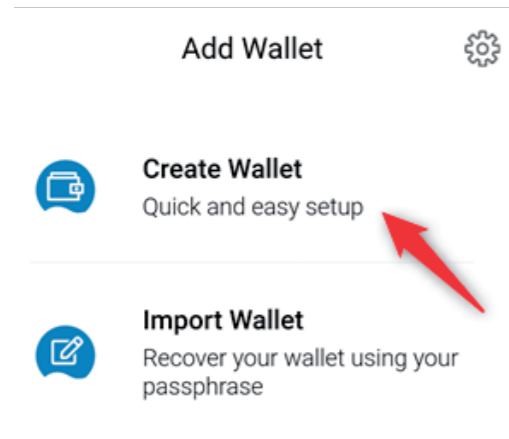

Figure 3:
Create a wallet

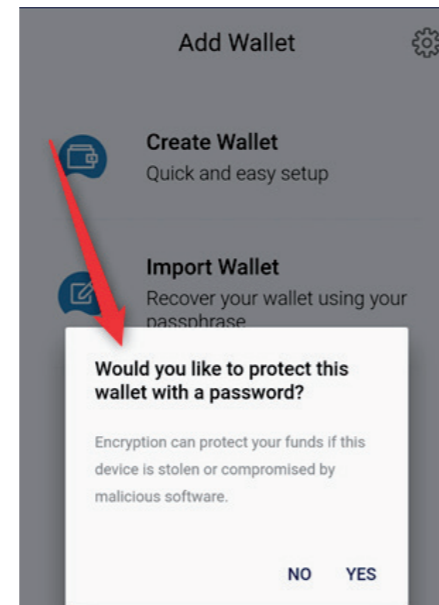

Figure 4: Protect wallet
with a password

- b. First, perform the backup so that you can get your passphrase. This is a combination of twelve (12) words created automatically by the Bitcoin blockchain. To start the backup, click > **Needs Backup** (Figure 5: Backup required).

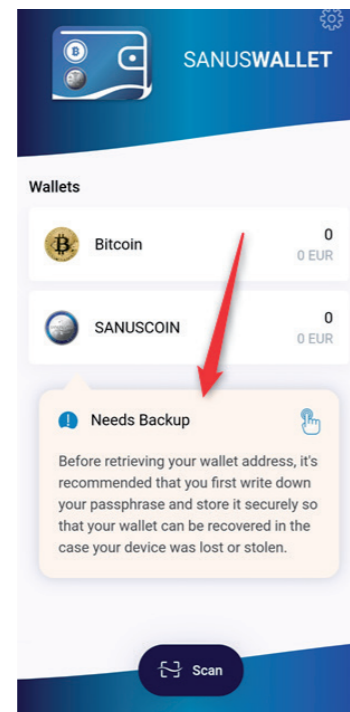

Figure 5:
Backup required

Note: Please note that SANUSLIFE does NOT know or manage the passphrases of the SANUSWALLET owners and thus can never access them. The passphrase cannot be recovered by SANUSLIFE nor by third parties. You alone are responsible for your passphrase. Please click > **Got it** (Figure 6: Secure your passphrase) and write down each word of the passphrase, in the correct order and with correct spelling.

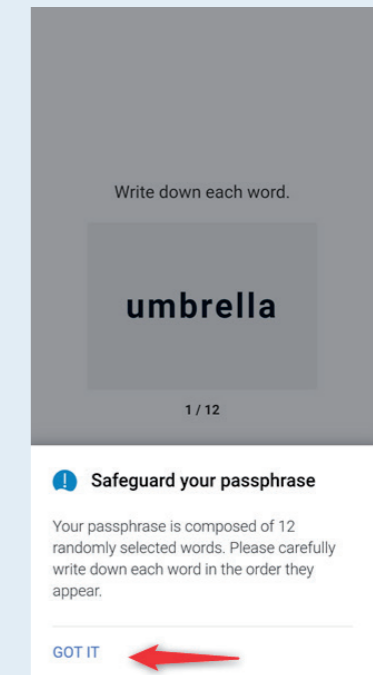

Figure 6: Secure your passphrase

1.3 How to restore an existing SANUSWALLET (import)

1. Install the wallet as indicated in point 2.2 and open it. Accept all the required details and click > **Import wallet** (Figure 7: Import wallet).

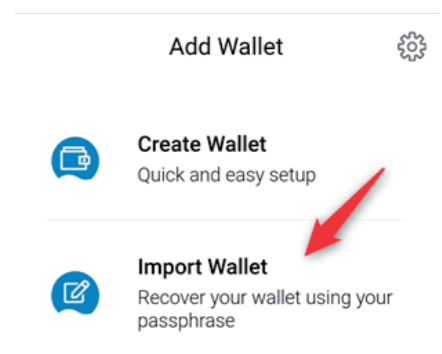

Figure 7: Import wallet

- Now enter the 12-digit passphrase in the correct order and with correct spelling. Make sure to confirm each word by clicking „enter.“ After you have entered all 12 words (Figure 8: Enter Passphrase), click > **Import** (Figure 9: Import wallet).

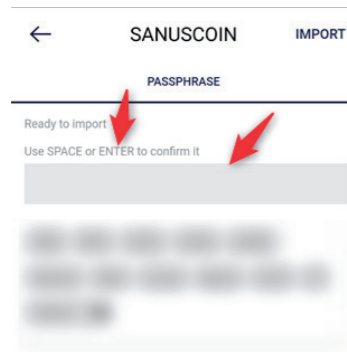

Figure 8:
Enter passphrase

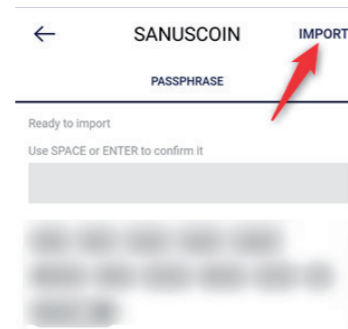

Figure 9:
Import wallet

- Next, select whether you want to secure your wallet with a password (Figure 10: Secure wallet with a password). If you choose this option, make sure you have written down the password, as it cannot be recovered. Alternatively, you also have the option to secure your wallet later with a PIN (see point 1.4 How to secure your SANUSWALLET from unauthorized access).

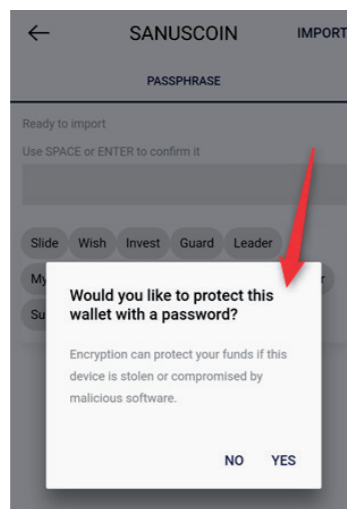

Figure 10: Secure wallet
with a password

Typical mistakes which are made when entering the passphrase:

Error/ Spelling error	Explanation
tree, savage, school,...	The words were entered separated by commas. The correct input should look like this: tree (Enter) savage (Enter) school (Enter) ...
tree – savage - school	The words were entered separated by hyphens. The correct input should look like this: tree (Enter) savage (Enter) school (Enter)
tre savage school ...	The word „tre“ was misspelled. However, SANUSWALLET 2.0 does not flag misspelled words. Here you have to delete all the words and enter them again.
tree school savage ...	The order of the words was mixed up. This error is not indicated either. You have to delete all the words and enter them again.
tree savage school ...	A letter in one word was capitalized by mistake. This error is not indicated. The words must all be entered again.

1.4 How to secure your SANUSWALLET from unauthorized access

If you haven't already secured your SANUSWALLET with a password as described above, you have the option of securing it with a PIN.

1. Go to **Settings** (gear wheel icon) (Figure 11: Settings: Secure with PIN) and select > **Lock** (Figure 12: Lock wallet).

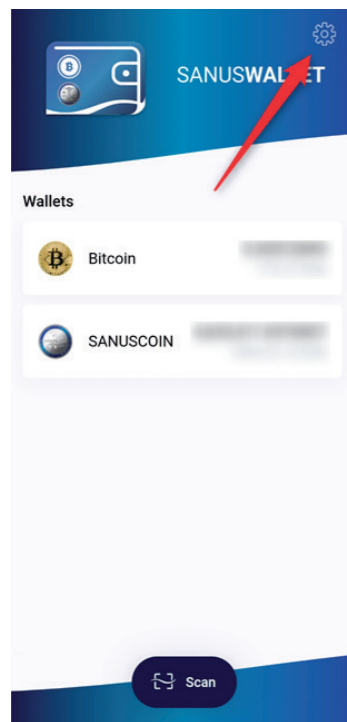

Figure 11: Settings:
Secure with PIN

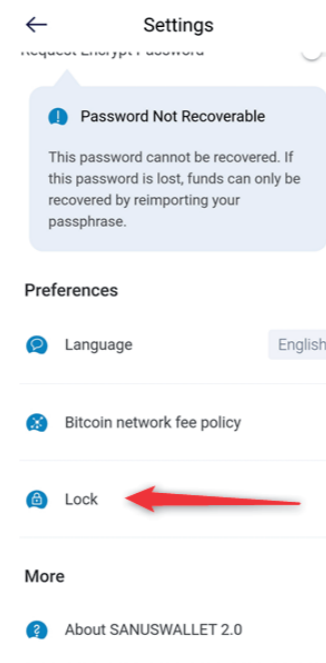

Figure 12:
Lock wallet

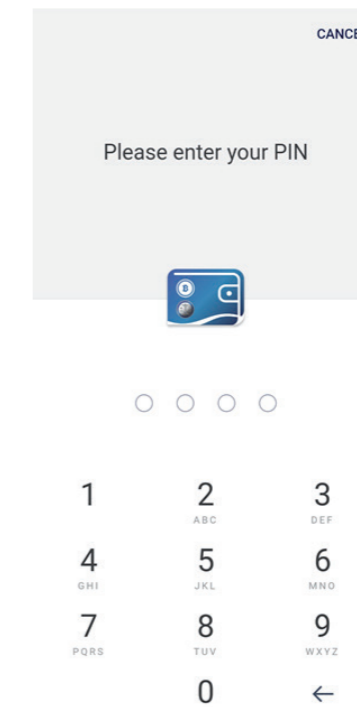

Figure 13: Select and
enter a PIN

You can disable the PIN at any time by clicking > **Lock** and > **Disabeld** under settings.

You are not required to set a password or a PIN. This is up to each user to decide.

A tip: It is best to write this PIN together with the passphrase on a sheet of paper which YOU must always keep in a safe place.

2. Click > **PIN** and select a PIN (Figure 13: Select and enter a PIN). Attention: Write down your PIN and keep it in a safe place, as it cannot be recovered and access to your wallet will be denied without the PIN.

1.5 How to receive and send Bitcoins (BTCs)

1.5.1 Receive BTCs

In order for you to receive Bitcoins, the sender needs your Bitcoin wallet receiving address. You can find this address

1. by opening the SANUSWALLET and clicking > **Bitcoin** (Figure 14: BTC wallet).

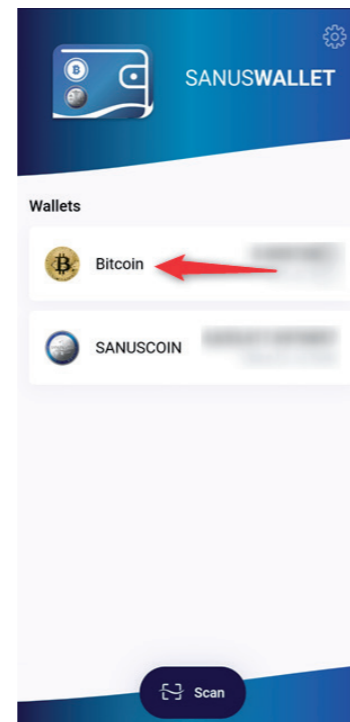

Figure 14: BTC wallet

2. Then click > **Receive** in the menu bar at the bottom of the screen (Figure 15: Receive BTCs).

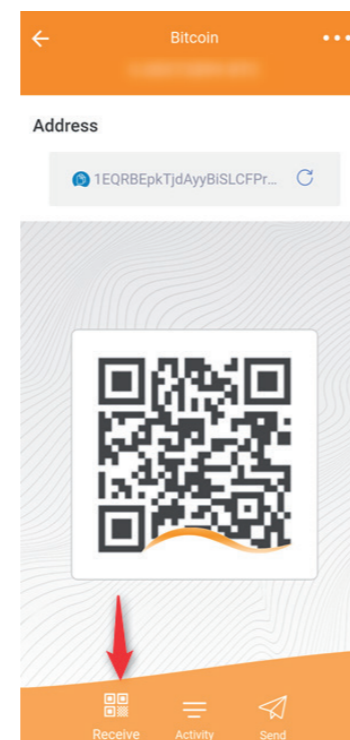

Figure 15: Receive BTCs

3. Either the QR code or the address serves as your receiving address. If you want to copy it, simply click the address (Figure 16: Copy BTC address and Figure 17: BTC address copied).



Figure 16:
Copy BTC address

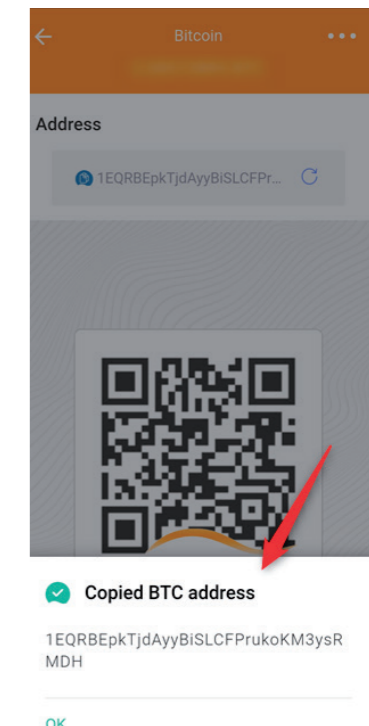

Figure 17:
BTC address copied

Tip: Your Bitcoin receiving address is identified by an orange wave.

1.5.2 Send BTCs

In order for you to send Bitcoins, you need the recipient's Bitcoin receiving address. If you want to send Bitcoins please proceed as follows:

1. Open the SANUSWALLET and click > **Bitcoin** (Figure 14: BTC wallet, Receive BTCs).
2. Click the paper airplane icon in the menu bar below (Figure 18: Send BTCs) and paste the copied address (Figure 19: Enter BTC receiving address) or scan the recipient's QR code (Figure 20: Scan BTC receiving address).

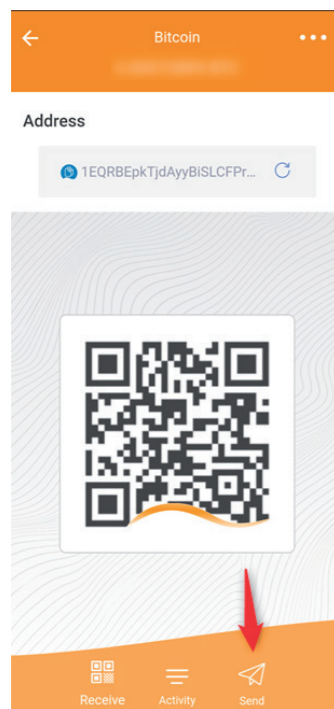

Figure 18:
Send BTCs



Figure 19: Enter BTC
receiving address

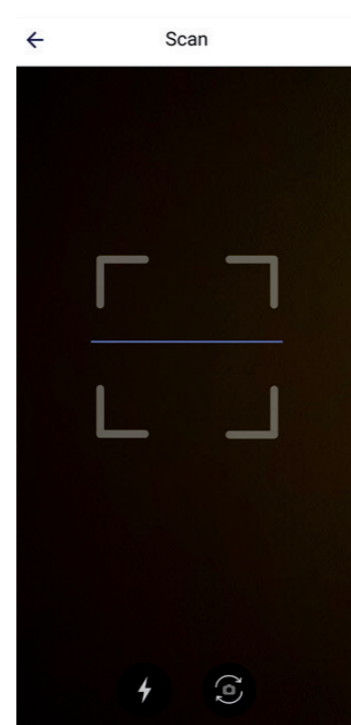

Figure 20: Scan BTC
receiving address

3. Then enter the amount of Bitcoins you want to send and click the arrow in the upper right corner. Then confirm the transaction (Figure 21: Send BTCs).

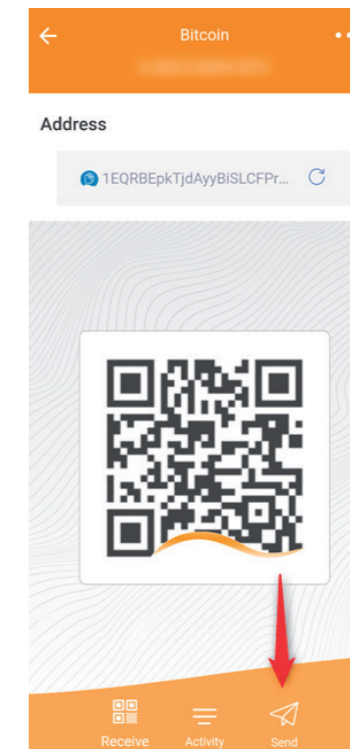

Figure 21:
Send BTCs

A tip: An overview of all Bitcoin transactions (BTCs sent and received) can be found under „Bitcoin.“

Note: You can buy Bitcoins on various exchange platforms such as Latoken, TRT etc. In most cases, you first need to register on the exchange platform you have chosen and create an account. To do so, please follow the instructions on the respective website.

1.6 How to receive and send SANUSCOINS (SACs)

1.6.1 Receive SACs

In order for you to receive SACs, the sender needs your SANUSCOIN wallet receiving address.

1. You can find this address by opening your wallet and clicking > **SANUSCOIN** (Figure 22: SAC wallet)

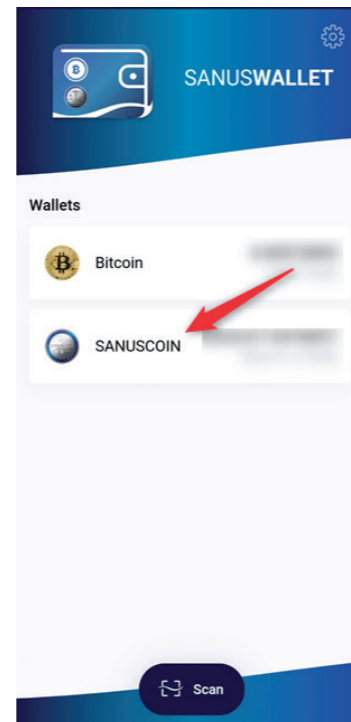

Figure 22:
SAC wallet

2. Then click > **Receive** in the menu bar below (Figure 23: Receive SACs).

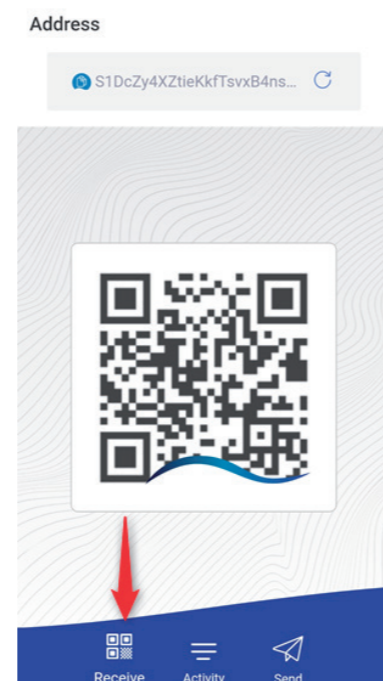

Figure 23:
Receive SACs

3. Either the QR code or the address can serve as your receiving address. If you want to copy it, simply click the address.

A tip: A SANUSCOIN receiving address is identified by a blue wave.

1.6.2 Send SACs

In order to send SANUSCOINS, you need the recipient's SANUSCOIN receiving address. You can find your own receiving address by

1. opening the SANUSWALLET and clicking > **SANUSCOIN** (Figure 22: SAC wallet).
2. Click the paper airplane icon in the menu bar at the bottom of the screen (Figure 24: Send SACs) and paste the copied address or scan the recipient's QR code (Figure 25: Copy/scan the SAC receiving address).

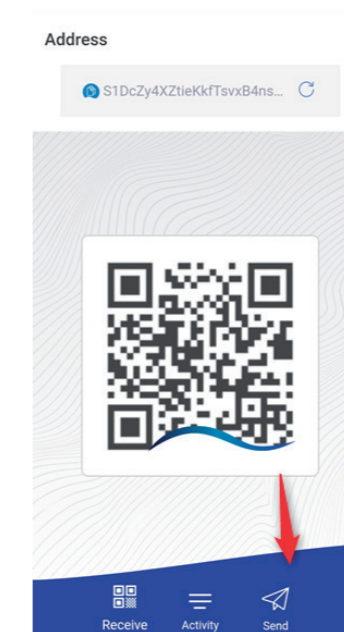

Figure 24:
Send SACs

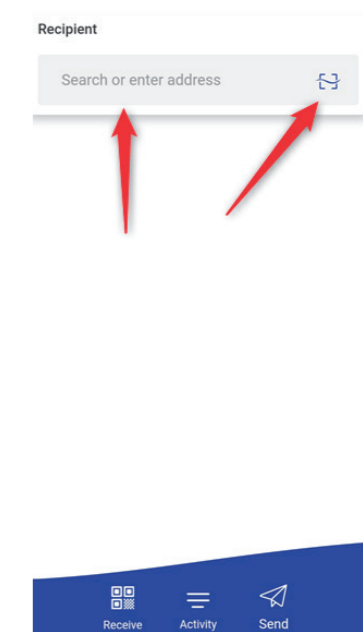

Figure 25: Copy/scan the SAC
receiving address

3. Then enter the amount of SACs you want to send and click the arrow in the upper right corner (Figure 26: Send SACs). Then confirm the transaction.

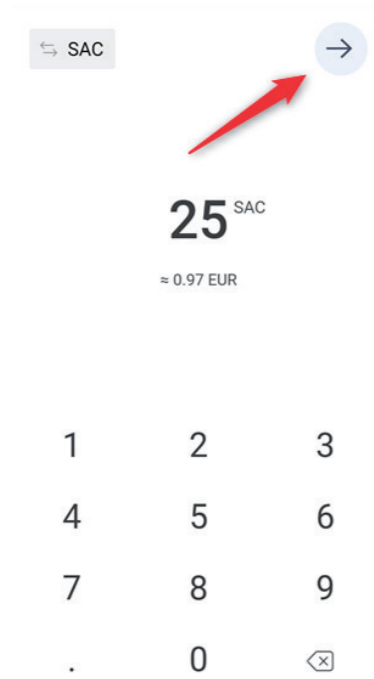

Figure 26:
Send SACs

Note: Since the transaction fee is settled in Bitcoins (BTC), your Bitcoin wallet must have a sufficient balance, otherwise the transaction cannot be executed.

1.7 How to hide your credit balance

1. If you want to „hide“ your SAC or BTC balance, click the respective wallet (e.g. Bitcoin) and hold your finger on the Bitcoin amount for a few seconds (Figure 27: Balance hidden).
2. To make the balance visible again, hold your finger on the > **Balance Hidden** field for a few seconds.

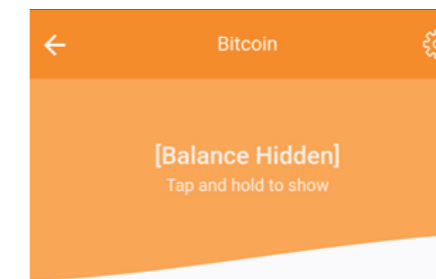

Figure 27:
Balance hidden

2 SANUSCREDITS AND SANUSCOINS

2.1 Conversion of SCs into SACs

Under the SANUSCOIN distribution program, each year in the month of January, the following steps must be taken in order for SANUSCREDITS (SC) to be converted into SANUSCOINS (SAC)..

Proceed following these steps::

1. Log in at www.sanuslife.com.
2. Click > **MY PROFILE > My GTC SANUSCOIN MANAGEMENT.** and there on the tile > **EXCHANGE SITE SC to SAC.**
3. Click the box next to > **I am aware that I cannot reverse the conversion.**
4. After the box is ticked, click the > **Convert all available SANUSCREDITS into SANUSCOINS** button.

Please note that after converting SANUSCREDITS into SANUSCOINS you will no longer be able to reverse the conversion. In return, 7% of all converted SANUSCREDITS will be credited back to you as CASHBACK.

An advantage for PREMIUM Members: the SANUSCREDITS accredited with the 7% CASHBACK can of course participate in the following split!

2.2 How to transfer the converted SACs in the SANUSWALLET

After performing the steps for converting credits into coins, your SANUSCOINS are automatically reserved in your name in the central wallet (Xth collection wallet out of 7). In order for them to be distributed to you, first make sure you have installed...

- a. the SANUSWALLET
- b. the "Google Authenticator" app (Play Store / App Store) so that you can then
- c. carry out the pairing.

Before putting these instructions into practice, let's repeat a bit of theory, so as to understand what the wallet, pairing and the Authenticator are, and what function each one performs.

2.3 Google Authenticator and Pairing

The „Google Authenticator" app generates verification codes on your smartphone in two steps. This is a security procedure devised to neutralize any hacking attack and to ensure that SANUSCOINS are always transferred to the right SANUSCOIN wallet. This mechanism boosts the security of your account, as it requires a two-step confirmation. In fact, in addition to the password, you need a code generated by the Google Authenticator app on your smartphone.

The term pairing stands for the process of establishing the first connection between two devices - in our case between a smartphone (SANUSWALLET on an Android smartphone or iPhone) and another device supported by an internet browser (SANUSLIFE profile page on a PC, laptop, tablet, etc.). By pairing, you communicate to the collection wallet the address to which the SACs converted/reserved in your name are to be transferred.

2.4 To perform the pairing

1. Log on to www.sanuslife.com.
2. Click on > **LOGIN** at the top right and log in with your ID number and password.
3. Click on > **My Profile** and scroll down the page to > **My T&Cs & SANUSCOIN MANAGEMENT**.
4. Click on > **SANUSWALLET PAIRING**.
5. Then follow the steps described on the website.

5. Short description or reason for the pairing problem

We will then analyze your problem and answer you promptly.

2.6 Has the pairing failed? This could help you!

If an error message appears after your attempt at pairing, or if the QR code is not read correctly, proceed as follows:

1. Make sure that your smartphone reads the QR code at a distance of about 20-30 cm from the screen and that your smartphone's lens and computer/smartphone/tablet screen is clean, free of dust or fingerprint marks.

If the pairing is still not successful, or does not work, make sure you have the latest operating software installed on your smartphone. Otherwise, simply update it and repeat the procedure described. If pairing fails even after the update, please send an email to support@sanuscoin.com - Reference: "Pairing failed," also providing us with the following information:

1. SANUSLIFE Partner ID number
2. Smartphone modell (for example iPhone 11)
3. Operating system (iOS or Android)
4. Software version

3 FAQ

1. On which devices can the SANUSWALLET be installed?

The SANUSWALLET 2.0 can only be installed on smartphones. It cannot be installed on tablets, iPads, laptops, etc.

2. I don't see my SACs in the wallet installed on my iOS device. What can I do?

Proceed as follows to restore the SANUSWALLET as a web app:

- ▶ Open the Safari browser.
- ▶ Enter <https://wallet.sanuscoin.com> in the browser line.
- ▶ Save the page on your home screen (+).
- ▶ Open the link on your home screen.
- ▶ Select > **Restore** to restore your existing wallet.
- ▶ Enter your 12-word passphrase.
- ▶ Click > **Import** to import your wallet.
- ▶ Done.

Now the SANUSWALLET should be installed correctly and you should be able to see your SAC balance.

You still don't see your coins? Then proceed as described in response to question No. 4.

3. I don't see my SACs in the wallet installed on my Android device. What can I do?

Proceed as follows to restore the SANUSWALLET as a web app:

- ▶ Open the Play Store and enter "SANUSWALLET 2.0" in the search mask and install it. Alternatively, you can download the SANUSWALLET from the website at <https://wallet.sanuscoin.com>.
- ▶ Open the app on your cell phone and select > **Import**.
- ▶ Enter your 12-word passphrase.
- ▶ Click > **Import** to import your wallet.
- ▶ Done.

Now the SANUSWALLET should be installed correctly and you should be able to see your SAC balance. You still don't see your coins? Then please proceed as described in response to question n. 4.

4. Although I have reinstalled my wallet and performed the import, I don't see my coins. What do I do now?

iOS user: clear the Safari cache and perform the import procedure again.

Android & iOS Nutzer: check whether you have installed the current version of SANUSWALLET 2.0 on your smartphone (settings → SANUSWALLET 2.0 version). At present it is: v2.1.11 If you do not have the most recent version, uninstall the SANUSWALLET again, restart the device and then perform the import again.

Afterwards, check whether the most recent device software is installed on your smartphone (settings → Device Information) and perform an update if necessary.

If you have installed the latest version of the smartphone software and of the SANUSWALLET, please provide us with the following information:

- ✓ Device (iPhone 11, Honor 30, etc.)
- ✓ Device's software version
- ✓ SANUSWALLET version
- ✓ xPub (SAC or BTC wallet → Settings → Information → xPub)
- ✓ Screenshot of the "empty" wallet
- ✓ Detailed description of the problem

Please do not send us screenshots of the xPub. We need a copy of it, which you can send us as an attachment in your email. Thank you.

5. Why don't I see the coins of the distribution in my wallet?

This can be due to several reasons:

- a. You did not request the conversion of SCs to SACs in time.
- b. The SACs were transferred to a wallet that is currently no longer linked to the account (see *Google Authenticator and Pairing, point 2.3 at page 23*).
- c. You accidentally installed a new wallet instead of importing the "old" one. The "old" wallet is still connected to the account, but you can't find the passphrase anymore. In this case, unfortunately, we cannot refund or recover the coins, as we do not have access to individual wallets and their corresponding passphrases.

6. What can I do to reduce transaction costs?

Here's how you can manually reduce the transaction fees:

1. If you want to transfer SACs, first enter the receiving address, then the amount in SANUSCOINS or euros. In the next step you will see the "Bitcoin miner fee," which is set to "Normal" by default and is usually very high.
2. If you click on the Bitcoin miner fee field, a new page with the amount of the fee will appear; to the right of it, the indication "**Normal**" (with an arrow pointing down). Click on it.
3. If you scroll all the way down, the "**Customized**" field will appear. Click on it.
4. An amount in Satoshi units will then appear; you can now reduce this manually and confirm by clicking **> Make change**.
5. You can also adjust the amount several times and then at the very bottom click: **> To send**.
6. But watch out: If the amount of Satoshis you set is too low, then the transaction may not be confirmed by the miners at all. In this case, the transaction will be blocked.

We recommend not going below an amount of 0.50 to 1 euro.

7. I wanted to pay for Check-Security with BTCs. The payment was debited to my BTC wallet, but the Check-Security does not appear as paid yet. What should I do?

Our system updates automatically every few hours. If you have paid for Check-Security and want to check immediately afterwards whether the payment was made correctly, it may not yet appear as being already paid. In this case, we recommend that you wait a few hours. If the payment still does not appear, send us the following data:

- ✓ **TX/Hash** (=transaction code) of the payment. To obtain this information, click the BTC payment you made, copy the whole address line and paste it into an email. Attention: Do not send a screenshot!
- ✓ BTC receiving address for a possible refund
- ✓ SAC receiving address for possible refund
- ✓ Your ID number
- ✓ Detailed description of the problem

